

## Fixed Attenuator

- ◆ DC to 6 GHz
- ◆ 3 dB
- ◆ 2 Watt
- ◆ MCX Type Connectors

### Features

- High attenuation accuracy
- Small VSWR
- Ceramic chip
- Low cost-high performance

### Model No. Description

FATXXXXXX

**X**- power handling: 2W or 5W.  
**X**- connector type: SMA, N type or MCX connector.

**XX**- attenuation: \*\*dB.

**XX**- 06 represents type number

### Specifications

Frequency Range	DC to 6 GHz
Attenuation	3 dB
Attenuation Accuracy (Max.)	±0.20 dB over DC - 3 GHz ±0.30 dB over 3 - 4 GHz ±0.40 dB over 4 - 6 GHz
Nominal Impedance	50 Ohm
Average Power	2 Watt
Operating Temperature	-55 °C to +125°C
Storage Temperature	-55 °C to +125°C

FREQ. RANGE (GHz)	Typical VSWR(:1)	Maximum VSWR(:1)
DC to 3	1.10	
3 to 4	1.15	
4 to 6	1.20	
DC to 6		1.25

### Material & Plating

Parts	Material	Plating(Micro-inch)
Body & Nut	Brass	Nickel 50
Contact (female & male)	QSn6.5-0.1	Gold 30
Insulator	Teflon	

### Characteristic

For example the testing curves of FAT0603M2

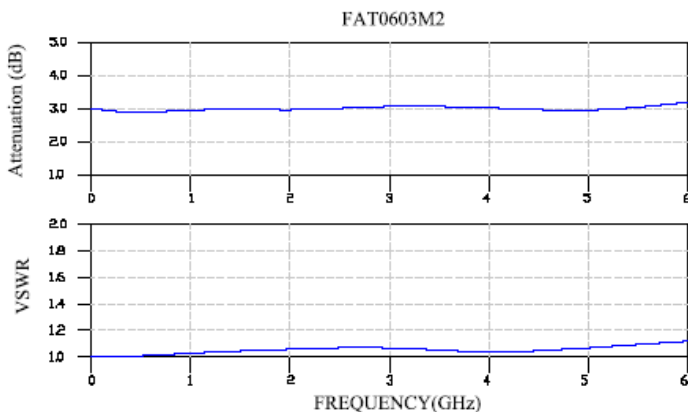

### Package Outlines

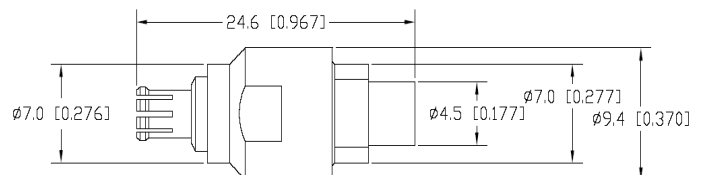

Package type: MCX type

Note: all dimensions shown in mm[inch]

### Yantel Corporation

Add: 3F, Building 3, Southern District 2 of ZhongGuan Honghualing Industrial Park, Xili, Nanshan, Shenzhen, China

Tel: 86-755-8355-1886 Fax: 86-755-8355-2533

For detailed performance specs & shopping online see Yantel web site : [www.yantel-corp.com](http://www.yantel-corp.com)

**Note:****Average power at 25°C ambient, derate linearly to 0.5W at 125°C**