

## Manual Step Attenuator

- ◆ DC to 3GHz
- ◆ 0 to 9dB in 3dB Step
- ◆ 2 Watt
- ◆ Connector Type:SMA,N,TNC,F,BNC etc. available.



### Features

- Using advanced microstrip technology, ultra-small size
- Attenuation values are adjustable in a power-on state, no sudden big reflection.  
It adopts an innovative technology, and thus it eliminates sudden big reflection in attenuators when attenuation is being adjusted, preventing the preliminary RF circuit from being burnt, and keeping the system stable
- Step values: 3dB,6dB
- 4 attenuation values
- High attenuation accuracy, low insertion loss
- High adjustment accuracy
- Low cost – High Performance
- Adjusting the transmitting (receiving) distance of RF signal precisely. Adjusting accuracy is limited to 5cm.
- Switch repeatability avg.> 10000 operations (5000 cycles) per switch.
- PC(Polycarbonate) Switch, operating temperature of 120°C is available.
- Attenuation values are adjustable in a power-on state, test data can be read continuously, no interruption.

### Characteristic

For example the testing curves of VAS060903S22 of 3dB

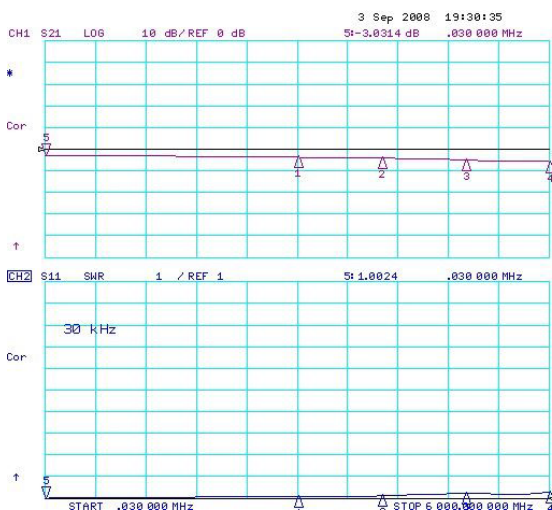

### Specifications

<b>Frequency Range</b>	DC to 3GHz
<b>Attenuation</b>	0 to 9dB
<b>Step Value</b>	3dB
<b>Insertion loss at 0dB (typ.)</b>	
SMA connector	0.25dB at 1 GHz 0.50dB at 2 GHz 0.65dB at 3 GHz
N type connector	0.25dB at 1 GHz 0.50dB at 2 GHz 0.65dB at 3 GHz
<b>Attenuation Accuracy (typ.)</b>	
SMA connector	0 to +0.30dB at 1GHz 0 to +0.60dB at 2GHz 0 to +1.20dB at 3GHz
N type connector	0 to +0.30dB at 1GHz 0 to +0.60dB at 2GHz 0 to +1.20dB at 3GHz
<b>Nominal Impedance</b>	50 Ohm
<b>Average Power</b>	2 Watt
<b>Operating Temperature</b>	-40°C to +85°C

Freq. Range (GHz)	Connector Type	VSWR(:1)	
		Typ.	Max.
DC to 3	SMA	1.30	1.35
	N Type	1.30	1.35

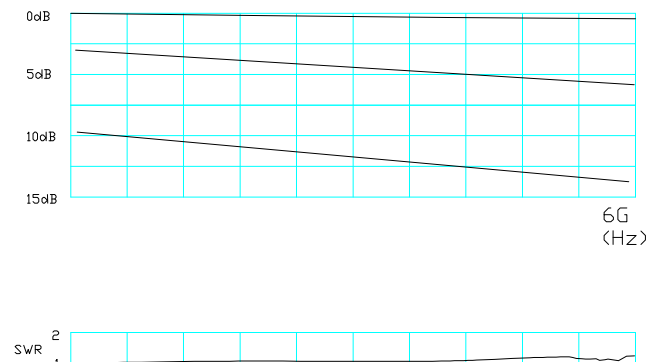

### Yantel Corporation

Add: 3F, Building 3, Southern District 2 of ZhongGuan Honghualing Industrial Park, Xili, Nanshan, Shenzhen, China  
 Tel: 86-755-8355-1886 Fax: 86-755-8355-2533

**Model No. Description**

VAS                      \*\*                        \*\*                        \*\*                        \*                        \*                        \*    
                                  Type                    Attenuation Range                    Step Value                    Connector Type                    Max. Power                    Connector Option

**VAS:** Step Variable Attenuator

**Type:** 06 represents type number

**Attenuation Range:** Maximum attenuation.

**Connector Type:** S and N available. S is SMA and N is N type connector.

**Max. Power:** 2 and 5 are available, currently 2W and 5W are available.

**Connector Options:**

Options	IO
1	Female/Female
2	Male/Female
3	Male/Male

**Connector Position:** "A" represents back connectors, without "A" represents left and right connectors.

**Package Outlines**

**SMA Connector**

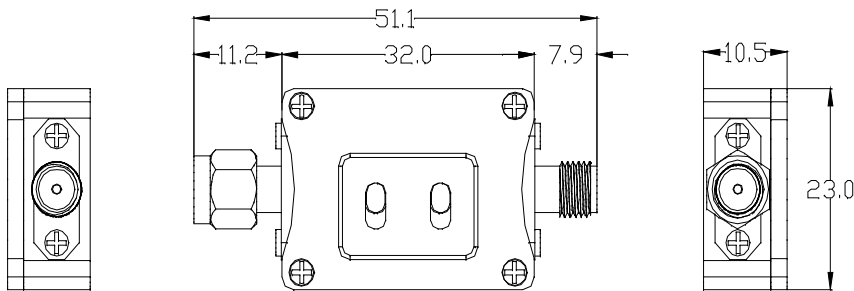

Package type: S22, Net weight: 18.8g

**N-type Connector**

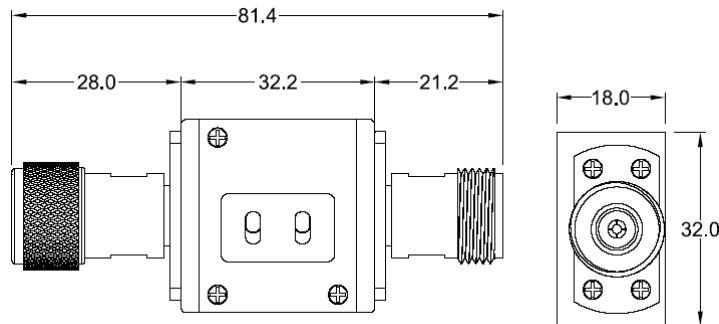

Package type: N22, Net weight: 59.3 g

**NOTE:**

1. ALL dimensions shown in mm(tolerance: +/-0.2mm) unless stated otherwise
2. RoHS Compliant in accordance with EU Directive(2011/65/EU)

Yantel Corporation

Add: 3F, Building 3, Southern District 2 of ZhongGuan Honghualing Industrial Park, Xili, Nanshan, Shenzhen, China  
 Tel: 86-755-8355-1886 Fax: 86-755-8355-2533